

Product Specifications

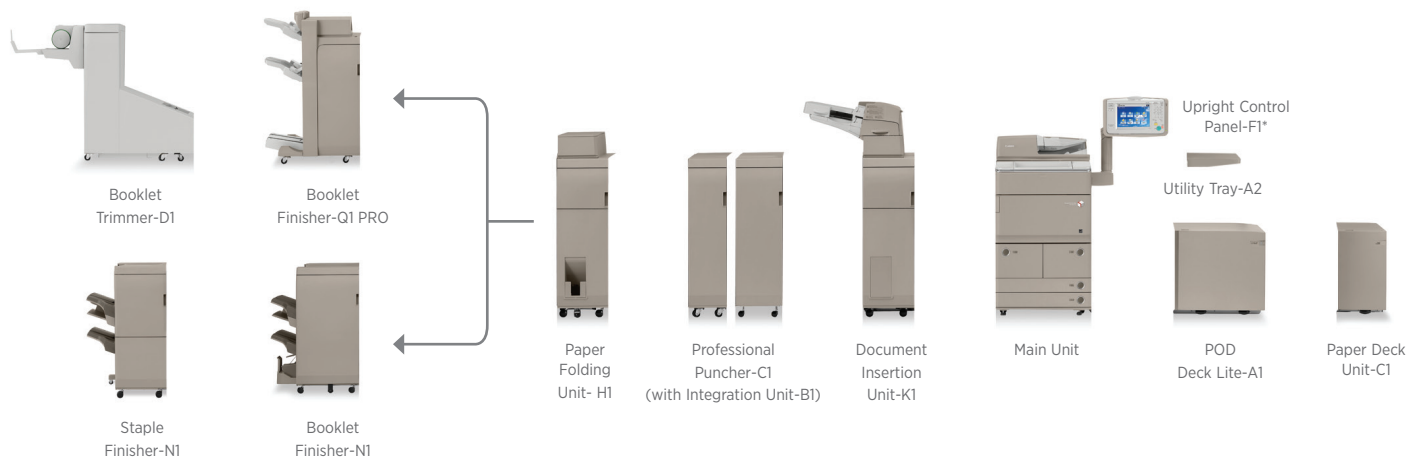

Main Unit

System Type

Monochrome Digital Multifunction Imaging System

Functions

Standard: Copy, Print (UFR II), Scan, Send, Store

Optional: Print (PCL 5e/6, Adobe® PostScript® 3™), Fax (Up to 4 Lines)

Operation Panel

8205/8295: 10.4" SVGA Full-Color, TFT Upright Screen

8285: 8.4" SVGA Full-Color, TFT Screen

Memory

Standard: 1.5GB RAM

Maximum: 2GB RAM

Hard Disk Drive

Standard: 160GB

Maximum: 1TB

Mirroring Hard Disk Drive

Optional (160GB, 1TB), Method: RAID1

Network Interface Connection

Standard: 10Base-T/100Base-TX/1000Base-T

Optional: Wireless LAN (IEEE 802.1x via third-party adapter)

Other Interface

Standard: USB 2.0 (Host) x2, USB 2.0 (Device)

Optional: Device Port [USB 2.0 (Host) x2], Serial Interface, Copy Control Interface

Copy/Print Speed (BW)

Letter: **8205:** Up to 105 ppm

8295: Up to 95 ppm

8285: Up to 85 ppm

Legal/11" x 17": **8205:** Up to 64/53 ppm

8295: Up to 60/49 ppm

8285: Up to 57/43 ppm

First-Copy-Out Time (Letter)

2.7 Seconds or Less

Paper Sources (20 lb. Bond)

Standard: Dual 1,500-sheet Paper Drawers, Dual 550-sheet Paper Cassettes, 100-sheet Stack Bypass

Optional: 3,500-sheet Paper Deck Unit or 3,500-sheet POD Deck Lite

Maximum: 7,700 Sheets (with Optional Paper Deck Unit)

Output Paper Capacity (20 lb. Bond)

Maximum: 4,250 Sheets (with Staple Finisher-NI or Booklet Finisher-NI)

5,000 (with Booklet Finisher-Q1 PRO)

Acceptable Paper Sizes

Drawers: Letter

Cassette:

13" x 19", 11" x 17", Legal, Letter, Letter-R, Executive, Statement-R, Custom Size (5-1/2" x 7-1/8" to 13" x 19-1/4")

Bypass (with Booklet Finisher-Q1 PRO attached):

13" x 19", 12-5/8" x 17-11/16", 12" x 18", 11" x 17", Legal, Letter, Letter-R, Executive, Statement-R, Custom Size (4" x 7-1/8" to 13" x 19-1/4")

Bypass (with Staple Finisher-NI/Booklet Finisher-NI attached):

13" x 19", 12-5/8" x 17-11/16", 12" x 18", 11" x 17", Legal, Letter, Letter-R, Executive, Statement-R, Custom Size (4" x 5-7/8" to 13" x 19-1/4")

Acceptable Paper Weights

Drawers/

Cassettes: 14 lb. Bond to 80 lb. Cover (52 to 220g/m²)

Bypass: 14 lb. Bond to 140 lb. Index (52 to 256g/m²)

Duplexing

Paper Size: Standard Automatic Trayless Duplexing (Up to 13" x 19")

Paper Weight: 14 lb. Bond to 80 lb. Cover (52 to 220g/m²)

Media Support

Thin [14 lb. Bond to 16 lb. Bond (52 to 63g/m²)], Plain [17 lb. Bond to 24 lb. Bond (64 to 90g/m²)], Heavy 1 [25 lb. Bond to 66 lb. Cover (91 to 180g/m²)], Heavy 2 [67 lb. Cover to 80 lb. Cover (181 to 220g/m²)], Heavy 3 [82 lb. Cover to 140 lb. Index (221 to 256g/m²)], Color, Recycled, Pre-Punched, Transparency, Tracing, Labels, Bond, Letterhead, Tab

Warm-up Time

From Power On: 60 Seconds or Less

From Sleep: 60 Seconds or Less

Quick Startup

Mode: 7 Seconds**

Power Requirements/Plug

120-127V AC, 60Hz, 16A/NEMA 5-20P

Power Consumption

Maximum: 1.92kW

Sleep Mode: 0.9W or Less

Dimensions (H x W x D)

With the Upright Control Panel (To the right edge of the Upright Control Panel in the right-most position):

49-1/4" x 53-3/8" x 30-3/8"

Without the Upright Control Panel:

48" x 25-3/8" x 30-3/8"

Installation Space (W x D)

With the Upright Control Panel:

100-1/4" x 31-7/8"

Without the Upright Control Panel:

79" x 31-7/8"

Weight

Approx. 535 lb. (242.5kg)***

Approx. 526 lb. (238.5kg)****

Toner (Estimated Yield @ 6% Coverage)

Black: 70,000 Images

Image Reader Unit

Scan Resolution: Up to 600 x 600 dpi

Acceptable Originals (Glass)

Sheet, Book, 3-Dimensional Objects [Up to 4.4 lb. (2kg)]

Maximum Original Size: Up to 11" x 17"

Main Unit (continued)

Document Feeder

Scan Method

Single-Pass Duplexing Automatic Document Feeder

Acceptable Originals

Paper Sizes: 11" x 17", Legal, Letter, Letter-R, Statement, Statement-R

Paper Weights: 1-sided scanning: 13 lb. Bond to 80 lb. Cover (50 to 220g/m²)

2-sided scanning (Black-and-white original): 13 lb. Bond to 80 lb. Cover (50 to 220g/m²)

2-sided scanning (Color original): 17 lb. Bond to 80 lb. Cover (64 to 220g/m²)

Scan Speed (BW/Color; Letter)

Simplex: Up to 120/85 ipm (300 dpi)
Up to 120/51 ipm (600 dpi)*

Duplex: Up to 200/100 ipm (300 dpi)
Up to 120/51 ipm (600 dpi)*

Paper Capacity (20 lb. Bond): 300 Sheets

Copy Specifications

First-Copy-Out Time (Letter): 2.7 Seconds or Less

Multiple Copies: 1 to 9,999

Copy Exposure: Automatic or Manual (9 Levels)

Magnification: 25% - 400% (1% Increments)

Preset Reductions: 25%, 50%, 64%, 73%, 78%

Preset Enlargements: 121%, 129%, 200%, 400%

Basic Copy Features

Preset R/E Ratios by Area, Finishing, Two-sided, Exposure Adjustment, Original Type Selection, Interrupt Mode, Sample Set, Setting Confirmation/Cancel, Standard Keys, Reset, Guide Display, Job Duration Display, Reserved Copying

Special Copy Features

Two-page Separation, Cover/Sheet Insertion, Booklet, Transparency Interleaving, Shift, Margin, Frame Erase, Image Combination, Different-size Original, Job Build, Job Done Notice, Scan Image Check, Mode Memory, Recall, Negative/Positive Inversion, Image Repeat, Mirror Image, Sharpness, Tab Paper Creation, Form Composition, Secure Watermark, Page Numbering, Copy Set Numbering, Watermark and Date, Job Block Combination, Store in User Inbox, Cascade Copy

Print Specifications

Processor

Canon Dual Custom Processor (Shared)

Memory

Standard: 1.5GB RAM

Maximum: 2GB RAM

Hard Disk Drive

Standard: 160GB

Maximum: 1TB

Engine Resolution: 1200 x 1200 dpi

PDL Support

Standard: UFR II

Optional: PCL 5e/6, Adobe PS 3

Print Driver Supported OS

UFR II, PCL 5e/6, Adobe PS 3:
Windows® (XP/Windows Vista®/7), Windows Server (2003/2008/2008 R2/SBS 2011/2012), Windows Terminal Servers (Server 2003/Server 2008/Server 2008 R2/2012), Microsoft® Clustering Server (Server 2003/Server 2003 R2/Server 2008/Server 2008 R2), Citrix (Presentation Server 4.5, Xen App 5.0/6.0/6.5, Xen Desktop 4.0/5.0/5.5), Macintosh® (OS X 10.5.8 or later, UFR II and PS 3 only), VMware, SAP (PS and PCL Only)

Direct Print Support

Standard: TIFF, JPEG

Optional: PDF, EPS**, XPS***

Print Features

Suspend Job Timeout, Subset Finishing (PS only), Profile Settings, Secure Print, Watermark, Page Border, Header/Footer, Page Layout, Two-sided Printing, Collating, Booklet Printing, Grouping, Mixed Paper Sizes/Orientations, Offsetting, Printing on Transparencies, Front/Back Covers, Toner Reduction, Poster Printing

Scan Specifications

Network TWAIN Scan: Standard

Network Scan Utility: Color Network ScanGear

Universal Send Specifications

Sending Method

E-mail, I-Fax, File Server (FTP, SMB, WebDAV), Mail Box, Super G3 Fax (Optional)

Color Mode

Auto Color Select (Full Color, Grayscale), Auto Color Select (Color, BW), Full Color, Grayscale, BW

Scan Resolution*

600 x 600 dpi, 400 x 400 dpi, 300 x 300 dpi, 200 x 400 dpi, 200 x 200 dpi, 200 x 100 dpi, 150 x 150 dpi, 100 x 100 dpi

Address Book Capacity

Max. 1,800 Destinations (Incl. 200 One-touch Buttons)

Communication Protocol

File: FTP (TCP/IP), SMB (TCP/IP), WebDAV

E-mail/I-Fax: SMTP, POP3, I-Fax (Simple, Full)

File Format

Standard: TIFF (BW), JPEG, PDF, PDF (Compact), PDF (Apply Policy), PDF (Optimize for Web), PDF/XPS (OCR), PDF/A-1b, XPS, XPS (Compact), OOXML (.pptx)

Optional: PDF (Trace & Smooth), PDF (Encrypted), PDF/XPS (Digital Signature), PDF (Reader Extensions)

I-Fax Data Format

BW: TIFF (MH, MR, MMR)

Color: TIFF (Profile-C)

Universal Send Features

Two-sided Original, Different-size Originals, Original Type Selection, Book to Two Pages, Density Adjustment, Sharpness, Document Name, Copy Ratio, Erase Frame, Job Build, Delayed Send, Preview, Finished Stamp, Job Done Notice, File Name, Subject/Message, Reply-to, Sender's Name (TTI), E-mail Priority

Fax Specifications

Maximum Number of Connection Lines: 4

Modem Speed

Super G3: 33.6 Kbps

G3: 14.4 Kbps

Compression Method: MH, MR, MMR, JBIG

Resolution

400 x 400 dpi, 200 x 400 dpi, 200 x 200 dpi, 200 x 100 dpi

Sending/Recording Size: Statement-R to 11" x 17"

Fax Features

Job Forwarding, Different-size Originals, Adjusting Overall Density for Scanning, Sharpness, Copy Ratio, Erase Frame, Job Build, Specifying the Sender's Name (when sending fax), Selecting the Telephone Line (when sending fax), Delayed Send, Preview, Finished Stamp, Job Done Notice, Original Type Selection, Two-sided Original, Book to Two Pages

Store Specifications

Mail Box (Number supported)

100 User Inboxes, 1 Memory RX Inbox, 50 Confidential Fax Inboxes

20,000 Maximum Pages Stored

Advanced Box

Available: Approx. 15GB (Standard HDD)
Disk Space: Approx. 629GB (1TB HDD)

Communication Protocol: SMB or WebDAV

Supported Client PC: Windows (Windows 2000/XP/7/Windows Vista)

Concurrent Connections (Max.): SMB: 32, WebDAV: 12 (Active Sessions)

Advanced Box Features: Disabling Advanced Box, Storage Filtering, Authentication for Advanced Box Log-in, Search Function, Sort Function, Printing a PDF File with a Password, imageWARE Secure Audit Manager Support

Memory Media

Standard: USB Memory

Optional: SD, SDHC, CompactFlash, Memory Stick, Microdrive

Security Specifications

Standard

Department ID Management, Single Sign-On H, Access Management System (Device and Function Level Log-in), Secure Print, Trusted Platform Module, User Access Control of Advanced Box, Mail Box Password Protection, IPV6, Restricting Features (Restricting the Send Function, Restricting New Addresses on Address Book), SSL Encrypted Communication, SNMPv1/v3, MAC/IP Address Filtering, SMTP Authentication, POP Authentication before SMTP, HDD Erase (Up to 3x), HDD Initialize (Up to 9x), HDD Lock, IPsec, Adobe LiveCycle® Rights Management ES2.5 Integration

Optional

Removable HDD, HDD Encryption, HDD Mirroring, Encrypted Secure Print, Encrypted PDF, Document Scan Lock, Secure Watermark, IEEE 2600.1 Common Criteria Certification****

Environmental Information

ENERGY STAR® Qualified

EU RoHS Compliant

Ecomark

WEEE Directive

Optional Accessories

Paper Supply Options

Paper Deck Unit-C1

Paper Capacity: 3,500 Sheets [20 lb. Bond (80g/m²)]
 Number of Drawers: 1
 Acceptable Paper Weight: 14 lb. Bond to 80 lb. Cover (52 to 220g/m²)
 Acceptable Paper Size: Letter
 Acceptable Paper Type: Thin, Plain, Heavy, Color, Recycled, Pre-Punched, Bond, Letterhead
 Power Source/Max. Power Consumption: From Main Unit/Approx. 39W
 Dimensions (H x W x D): 22-1/2" x 12-3/4" x 23" (570mm x 323mm x 583mm)
 Weight: Approx. 81.6 lb. (37kg)

POD Deck Lite-A1

Paper Capacity: 3,500 Sheets [20 lb. Bond (80 g/m²)]
 Number of Drawers: 1
 Acceptable Paper Weight: 14 lb. Bond to 140 lb. Index (52 to 256g/m²)
 Acceptable Paper Size: 13" x 19", 12-5/8" x 17-11/16", 12" x 18", 11" x 17", Legal, Letter, Letter-R
 Acceptable Paper Type: Thin, Plain, Heavy, Color, Recycled, Bond, Pre-Punched, Transparency, Labels, Letterhead
 Power Source/Max. Power Consumption: 120-127V AC, 60Hz, 5A/Approx. 227W
 Dimensions (H x W x D): 22-1/2" x 23-5/8" x 24-1/2" (570mm x 601mm x 621mm)
 Weight: Approx. 110 lb. (50kg)

Output Options

Booklet Finisher-Q1 PRO

Number of Trays: 2
 Total Output Capacity: 5,000 Sheets (Letter)
Tray A: 1,000 Sheets (13" x 19", 12-5/8" x 17-11/16", 12" x 18", 11" x 17", Legal, Letter, Letter-R, Executive, Statement-R)
Tray B: **High-Volume Stack Mode 'On':**
 4,000 Sheets (Letter, Executive)
 2,000 Sheets (Letter-R)
 1,500 Sheets (11" x 17", Legal)
 1,000 Sheets (13" x 19", 12-5/8" x 17-11/16", 12" x 18")
High-Volume Stack Mode 'Off':
 2,000 Sheets (Letter, Executive)
 1,000 Sheets (13" x 19", 12-5/8" x 17-11/16", 12" x 18", 11" x 17", Legal, Letter-R)
 Acceptable Paper Weight: 14 lb. Bond to 140 lb. Index (52 to 256g/m²)
 Acceptable Paper Type: Thin, Plain, Heavy, Color, Recycled, Pre-Punched, Transparency, Tracing, Labels, Tab, Bond, Letterhead, Coated^{AA}
 Acceptable Paper Size: 13" x 19", 12-5/8" x 17-11/16", 12" x 18", 11" x 17", Legal, Letter, Letter-R, Executive, Statement-R, Custom Size (4" x 7-1/8" to 13" x 19-1/4")

Booklet Finisher-Q1 PRO (continued)

Staple Positions: **Corner/Double Stapling:** 11" x 17", Legal, Letter, Letter-R, Executive
Saddle-Stitch: 13" x 19", 12-5/8" x 17-11/16", 12" x 18", 11" x 17", Legal, Letter-R, Custom Size (8-1/4" x 11" to 13" x 19-1/4")
Letter and Executive: 100 Sheets [20 lb. Bond (80g/m²)] or Heavy paper below 1/2" (11mm)
11" x 17", Legal, Letter-R: 50 Sheets [20 lb. Bond (80g/m²)] or Heavy paper below 1/4" (5.5mm)
Tray B: 3,000 Sheets/200 Sets (Letter, Executive), 2,000 Sheets/200 Sets (Letter-R), 1,500 Sheets/200 Sets (11" x 17", Legal)
 Maximum Saddle-Stitch Capacity: 25 Sheets [20 lb. Bond (80g/m²), including 1 Cover Sheet up to 140 lb. Index (256g/m²)]
 Paper Capacity of Saddle-Stitch Mode: 30 Sets or Unlimited^{AAA}
 Type of Staple: Staple-N1 (5,000 x 3), Staple-P1 (5,000 x 2)
 Power Source/Max. Power Consumption: 120V AC, 60Hz, 8A/Approx. 500W
 Dimensions (H x W x D): 48-3/4" x 31-1/2" x 31-1/4" (1239mm x 800mm x 792mm)
 Weight: Approx. 401 lb. (182kg)

Puncher Unit-BS1^{AAAA}

Acceptable Punch Paper Weight: 14 lb. Bond to 140 lb. Index (52 to 256g/m²)
 Acceptable Punch Paper Type: Thin, Plain, Heavy, Color, Recycled, Tab, Bond, Letterhead, Coated^{AA}
 Acceptable Punch Paper Size: **2 Holes:** Legal, Letter-R, Custom Size (4" x 4" to 11-3/4" x 17")
3 Holes: 11" x 17", Letter, Executive, Custom Size (4" x 4" to 11-3/4" x 17")
 Distance Between Punch Holes: **2 Holes:** 2-3/4" (70mm)
3 Holes: 4-1/4" (108mm)
 Punch Waste Tray Capacity: Approx. 6,000 Sheets [20 lb. Bond (80g/m²)]
 Power Source: From the Finisher
 Dimensions (H x W x D): Inside the Finisher
 Weight: Approx. 6.7 lb. (3kg)

Booklet Trimmer-D1^{AAAA}

Margin Trimming: Face Trim
 Trim Amount: 0.08" to 0.78" (2mm to 20mm)
 Trim Thickness: 100 Sheets
 Waste Tray Capacity: 1,500 Sheets (with 0.78" Trim, 20 lb. Bond)
 Acceptable Paper Weight: 14 lb. Bond to 140 lb. Index (52g/m² to 256g/m²)
 Output Tray Capacity: 30 Booklets
 Power Source: From the Booklet Finisher
 Dimensions (H x W x D): 41" x 62" x 30-3/8" (1040mm x 1575mm x 770mm)
 Weight: Approx. 335 lb. (152kg)

Staple Finisher-N1

Number of Trays: 3
 Total Output Capacity: 4,250 Sheets (Letter)
Tray A: 1,500 Sheets (Letter, Executive, Statement-R), 750 Sheets (13" x 19", 12-5/8" x 17-11/16", 12" x 18", 11" x 17", Legal, Letter-R)
Tray B: 250 Sheets (Letter, Executive, Statement-R), 125 Sheets (11" x 17", Legal, Letter-R), 30 Sheets (13" x 19", 12-5/8" x 17-11/16", 12" x 18")
Tray C: 2,500 Sheets (Letter), 1,500 Sheets (Executive, Statement-R), 750 Sheets (13" x 19", 12-5/8" x 17-11/16", 12" x 18", 11" x 17", Legal, Letter-R)

Acceptable Paper Weight: 14 lb. Bond to 140 lb. Index (52 to 256g/m²)
 Acceptable Paper Type: Thin, Plain, Heavy, Color, Recycled, Pre-punched, Transparency, Tracing, Labels, Tab, Bond, Letterhead, Coated^{AA}
 Acceptable Paper Size: 13" x 19", 12" x 18", 11" x 17", Legal, Letter, Letter-R, Executive, Statement-R, Custom Size (4" x 5-7/8" to 13" x 19-1/4")
 Staple Positions: **Corner/Double Stapling:** (11" x 17", Legal, Letter, Letter-R, Executive)
 Maximum Stapling Capacity: **Letter and Executive:** 100 Sheets [20 lb. Bond (80g/m²)] or up to 1/2" (11mm) for heavier paper
11" x 17", Legal, and Letter-R: 50 Sheets [20 lb. Bond (80g/m²)] or up to 1/4" (5.5mm) for heavier paper
Tray A and Tray C: 1,500 Sheets/100 Sets (Letter, Executive), 750 Sheets/50 Sets (11" x 17", Legal, Letter-R)
 Type of Staple: Staple-N1 (5,000 x 3)
 Power Source/Max. Power Consumption: 100-240V AC, 50/60Hz, 2.8A
 Approx. 286W (including the Puncher Unit-BF1)
 Approx. 282W (excluding the Puncher Unit-BF1)
 Dimensions (H x W x D): 41" x 25-3/4" (30-3/4"^{AAAA}) x 30-1/8" (1040mm x 654mm (782mm^{AAAA}) x 765mm)
 Weight: Approx. 141 lb. (64kg)

Optional Accessories (continued)

Output Options (continued)

Booklet Finisher-N1

Number of Trays:	3
Total Output Capacity:	4,250 Sheets (Letter)
Tray A:	1,500 Sheets (Letter, Executive, Statement-R), 750 Sheets (13" x 19", 12-5/8" x 17-11/16", 12" x 18", 11" x 17", Legal, Letter-R)
Tray B:	250 Sheets (Letter, Executive, Statement-R), 125 Sheets (11" x 17", Legal, Letter-R), 30 Sheets (13" x 19", 12-5/8" x 17-11/16", 12" x 18")
Tray C:	2,500 Sheets (Letter), 1,500 Sheets (Executive, Statement-R), 750 Sheets (13" x 19", 12-5/8" x 17-11/16", 12" x 18", 11" x 17", Legal, Letter-R)
Acceptable Paper Weight:	14 lb. Bond to 140 lb. Index (52 to 256g/m ²)
Acceptable Paper Type:	Thin, Plain, Heavy, Color, Recycled, Pre-punched, Transparency, Tracing, Labels, Tab, Bond, Letterhead, Coated**
Acceptable Paper Size:	13" x 19", 12" x 18", 11" x 17", Legal, Letter, Letter-R, Executive, Statement-R, Custom Size (4" x 5-7/8" to 13" x 19-1/4")
Staple Positions:	Corner/Double Stapling: 11" x 17", Legal, Letter, Letter-R, Executive Saddle-Stitch: 13" x 19", 12-5/8" x 17-11/16", 12" x 18", 11" x 17", Legal, Letter-R, Custom Size (8-1/4" x 11" to 13" x 19-1/4")
Maximum Stapling Capacity:	Letter and Executive: 100 Sheets [20 lb. Bond (80g/m ²)] or up to 1/2" (11mm) for heavier paper 11" x 17", Legal, and Letter-R: 50 Sheets [20 lb. Bond (80g/m ²)] or up to 1/4" (5.5mm) for heavier paper
Paper Capacity of Saddle-Stitch:	Tray A and Tray C: 1,500 Sheets/100 Sets (Letter, Executive), 750 Sheets/50 Sets (11" x 17", Legal, Letter-R)
Maximum Saddle-Stitch Capacity:	20 Sheets [20 lb. Bond (80g/m ²), including 1 Cover Sheet up to 140 lb. Index (256g/m ²)]
Paper Capacity of Saddle-Stitch Mode:	1 to 5 Sheets/25 Sets, 6 to 10 Sheets/15 Sets, 11 to 16 Sheets/10 Sets, 17 to 20 Sheets/5 Sets
Type of Staple:	Staple-N1 (5,000 x 3), Staple-P1 (5,000 x 2)
Power Source/Max. Power Consumption:	100-240V AC, 50/60Hz, 2.8A Approx. 380W (including the Puncher Unit-BF1 and Inner Booklet Trimmer-A1) Approx. 349W (excluding the Puncher Unit-BF1 and Inner Booklet Trimmer-A1)
Dimensions (H x W x D):	41" x 30-1/4" (35-1/4"***) x 30-1/8" (1040mm x 767mm (896mm***)) x 765mm)
Weight:	Approx. 243 lb. (110kg)

Puncher Unit-BF1*

Acceptable Punch Paper Weight:	14 lb. Bond to 140 lb. Index (52 to 256g/m ²)
Acceptable Punch Paper Type:	Thin, Plain, Heavy, Color, Recycled, Tab, Bond, Letterhead, Coated**
Acceptable Punch Paper Size:	11" x 17", Legal, Letter, Letter-R, Executive
Punch Type:	2 Holes (Legal, Letter-R) 3 Holes (11" x 17", Letter, Executive)
Distance Between Punch Holes:	2 Holes: 2-3/4" (70mm) 3 Holes: 4-1/4" (108mm)
Punch Waste Tray Capacity:	Approx. 5,000 Sheets [20 lb. Bond (80g/m ²)]
Power Source:	From the Finisher
Dimensions (H x W x D):	Inside the Finisher [15-1/2" x 3-3/4" x 15-1/2" (392mm x 95mm x 392mm)]
Weight:	Approx. 8.2 lb. (3.7kg)

Inner Booklet Trimmer-A1**

Trimming Method:	Face Trim
Trim Thickness:	40 Sheets (2-20mm)
Waste Tray Capacity:	Approx. 1,500 Sheets of trimmed strip [width 3/4" (20mm), Letter, 20 lb. Bond (80g/m ²)]
Acceptable Paper Weight:	16 lb. Bond to 140 lb. Index (60 to 256g/m ²)
Acceptable Paper Type:	Thin, Plain, Heavy, Color, Recycled, Coated***, Letterhead, Bond
Acceptable Paper Size:	13" x 19", 12-5/8" x 17-11/16", 12" x 18", 11" x 17", Legal, Letter-R, Custom Size (8-1/4" x 11" to 13" x 19-1/4")
Power Source:	From the Finisher
Dimensions (H x W x D):	Inside the Finisher [15-7/8" x 9-7/8" x 24-5/8" (403mm x 251mm x 625mm)]
Weight:	Approx. 70.5 lb. (32kg)

Document Insertion Unit-K1***

Acceptable Media:	Covers and Inserts
Number of Trays:	2
Tray Capacity:	Upper/Lower Tray: 200 Sheets [20 lb. Bond (80g/m ²)] x 2
Acceptable Paper Weight:	14 lb. Bond to 140 lb. Index (52 to 256 g/m ²)
Acceptable Paper Type:	Thin, Plain, Heavy, Color, Recycled, Pre-Punched, Tracing, Tab, Bond, Letterhead, Coated**
Acceptable Paper Sizes:	13" x 19", 12-5/8" x 17-11/16", 12" x 18", 11" x 17", Legal, Letter, Letter-R, Executive, Custom Size (7-1/8" x 7-1/8" to 13" x 19-1/4")
Power Source/Max. Power Consumption:	100-240V AC, 50/60Hz, 1A Approx. 128W (with Booklet Finisher-Q1 PRO) Approx. 117W (with Staple Finisher-N1/Booklet Finisher-N1)
Dimensions (H x W x D):	55-3/8" x 29-3/8" x 31-1/4" (1407mm x 746mm x 793mm)
Weight:	Approx. 134 lb. (61kg)

Professional Puncher-C1/Professional Puncher Integration Unit-B1***

Acceptable Punch Paper Weight:	LTR (3-hole, 5-hole, Velo Bind 11-hole, Plastic Comb 19-hole, Twin Loop 21/32-hole, Color Coil 44-hole): 20 lb. Bond to 80 lb. Cover (75 to 216g/m ²) LTR (ProClick 32-hole): 20 lb. Bond to 65 lb. Cover (75 to 176g/m ²)
Acceptable Punch Paper Type:	Thin, Plain, Heavy, Color, Recycled, Tab, Bond, Letterhead, Coated**
Acceptable Punch Paper Size:	Letter
Punch Pattern Die Sets (optional):	Plastic Comb (19-hole), Twin Loop (21/32-hole), Color Coil (44-hole), Velo Bind (11-hole), Loose Leaf (3/5-hole), ProClick (32-hole)
Punch Waste Tray Capacity:	Approx. 25,000 Sheets
Power Source/Max. Power Consumption:	Professional Puncher-C1: From the Professional Puncher Integration Unit-B1/Approx. 300W Professional Puncher Integration Unit-B1: 120-127V AC/5.5A-60Hz/Approx. 135W
Dimensions (H x W x D):	Professional Puncher-C1: 41" x 12" x 31-1/4" (1040mm x 305mm x 792mm) Professional Puncher Integration Unit-B1: 41" x 9-7/8" x 31-1/4" (1040mm x 250mm x 792mm)
Weight:	Professional Puncher-C1: Approx. 176 lb. (80kg) Professional Puncher Integration Unit-B1: Approx. 88.2lb (40kg)

Paper Folding Unit-H1***

Folding Method:	Roller Pressure Folding
Folding Type:	Z-Fold, C-Fold, Accordion Z-Fold, Double-Parallel Fold, Half-Fold
Acceptable Paper Weight:	Z-Fold, C-Fold, Accordion Z-Fold, Half-Fold: 14 lb. Bond to 28 lb. Bond (52 to 105 g/m ²) Double-Parallel Fold: 14 lb. Bond to 24 lb. Bond (52 to 90g/m ²)
Acceptable Paper Type:	Thin, Plain, Color, Recycled, Bond
Acceptable Paper Sizes:	Z-Fold: Letter-R, Legal, 11" x 17" C-Fold, Accordion Z-Fold, Half-Fold: Letter-R Double-Parallel Fold: Letter-R, Legal
Power Source/Max. Power Consumption:	From the Finisher/Approx. 165W
Dimensions (H x W x D):	46-7/8" x 13-1/4" x 31-1/4" (1190mm x 336mm x 793mm)
Weight:	Approx. 157 lb. (71kg)

Optional Accessories (continued)

Additional Print Controller Options

imagePASS-U2 Controller

Type:	External
Processor:	Intel® Pentium® Processor E5300 2.60GHz
System:	Fiery® System 10
PDL Support:	Adobe PS 3, PCL 5e/6
Print	1200 x 1200 dpi
Resolution:	2400 dpi equivalent x 600 dpi
Memory:	2GB (Standard/Maximum)
HDD:	250GB
Interfaces (to LAN):	10Base-T/100Base-TX/1000Base-T
Dimensions (H x W x D):	12-1/2" x 5-1/2" x 15-1/2" (317.5mm x 139.7mm x 393.7mm)
Utility	<ul style="list-style-type: none"> • imagePASS-U2 Driver • Command WorkStation® 5 • Remote Scan 5.3 • Web Tools
Standard Features:	<ul style="list-style-type: none"> • Hot Folder • Secure Erase • VDP Enhancement
Options:	<ul style="list-style-type: none"> • SeeSequence Suite • SeeSequence Impose • SeeSequence Compose • Removable Hard Disk Drive • Integration Interface and Stand (19" display, keyboard, mouse, and furniture stand) • ImageViewer

Other Optional Accessories

- Upright Control Panel-F1
- Utility Tray-A2
- USB Keyboard (Cherry)
- Universal Keyboard Stand-A1
- Copy Card Reader-F1*
- Braille Label Kit-F1
- ADF Access Handle-A1
- Convenience Stapler-B1
- PCL Printer Kit-AU1
- PCL International Font Set-A1**
- PS Printer Kit-AU1***
- Direct Print Kit (for PDF/XPS)-H1***
- Encrypted Secure Print Software-D1
- Barcode Printing Kit-D1**
- Web Access Software-H1*
- Universal Send Advanced Feature Set-F1
- Universal Send Security Feature Set-D1
- Universal Send Digital User Signature Kit-C1
- Super G3 Fax Board-AL1
- Super G3 2nd Line Fax Board-AL1***
- Super G3 3rd/4th Line Fax Board-AL1*
- Remote Fax Kit-A1**
- Secure Watermark-B1
- Silex Wireless Bridge SX-2500CG
- USB Device Port-A2
- Multimedia Reader/Writer-A2***
- Additional Memory Type D (512MB)
- Document Scan Lock Kit-B1
- HDD Data Encryption and Mirroring Kit-C5
- Removable HDD Kit-AG1
- 2.5-inch/160GB HDD-J1
- 2.5-inch/1TB HDD-K1
- Voice Guidance Kit-F2□
- Voice Operation Kit-C2□
- Remote Operator's Software Kit-B1
- Copy Control Interface Kit-A1□□

- * The Upright Control Panel is standard on 8205/8295 models, and optional on the 8285 model.
 - ** If "Quick Startup Settings for Main Power" is set to ON, it takes 7 seconds until the key operation on the touch-panel display is available after turning on the main power.
 - *** Including the toner bottle, Duplex Color Image Reader, and the Upright Control Panel.
 - **** Including the toner bottle and Duplex Color Image Reader Unit.
 - † Standard color scan support is up to 300 dpi. Up to 600 dpi scanning requires Additional Memory Type D (512 MB).
 - †† EPS can be printed directly only from Remote User Interface.
 - ††† XPS cannot be printed directly from the Web Access software.
 - †††† Not available at time of launch.
 - ▲ Stacking capacity will vary depending on paper type.
 - ▲▲ Coated paper can be loaded from the Document Insertion Unit only.
 - ▲▲▲ When the Auxiliary Tray is extended.
 - ▲▲▲▲ Option for Booklet Finisher-Q1 PRO.
 - ▼ Installs internally with Inner Staple Finisher-N1 or Booklet Finisher-N1.
 - ▼▼ Installs internally with Booklet Finisher-N1.
 - ▼▼▼ Requires Staple Finisher-N1, Booklet Finisher-N1, or Booklet Finisher-Q1 PRO.
 - Requires the Copy Card Reader Attachment Kit-A2.
 - Requires PCL Printer Kit-AU1.
 - Requires Additional Memory Type D (512MB).
 - Requires Direct Print Kit-H1 for printing PDF files.
 - Requires Super G3 Fax Board-AL1.
 - Requires Super G3 2nd Line Fax Board-AL1.
 - Cannot be installed with Super G3 Fax Board-AL1.
 - Requires USB Device Port-A2.
 - Voice Guidance Kit-F2 and Voice Operation Kit-C2 cannot be installed together.
 - Cannot be installed with Copy Card Reader-F1.
- NOTE: Some accessories require additional equipment or may be prerequisites for other options. Some accessories cannot be installed simultaneously. Check with your Canon Authorized Dealer for details.

Canon
image*ANYWARE*

1-800-OK-CANON
www.usa.canon.com

Canon U.S.A., Inc.
One Canon Plaza
Lake Success, NY 11042

As an ENERGY STAR® Partner, Canon U.S.A., Inc. has determined that these products meet the ENERGY STAR guidelines for energy efficiency. ENERGY STAR and the ENERGY STAR mark are registered U.S. marks. CANON, IMAGERUNNER, MEAP, and the GENUINE logo are registered trademarks of Canon Inc. in the United States and may also be registered trademarks or trademarks in other countries. IMAGEWARE is a registered trademark of Canon U.S.A., Inc. in the United States and is a trademark of Canon Inc. in certain other countries. IMAGEANYWARE is a trademark of Canon. All other referenced product names and marks are trademarks of their respective owners and are hereby acknowledged. Specifications and availability subject to change without notice. Some items may not be available at this time; please check for availability. All printer output images are simulated.

©2012 Canon U.S.A., Inc. All rights reserved.

